

Date: May 6, 2019

To: European Coordination Centre

Cc: International Assembly, Western Hemisphere Department

## **Re: Request for donations for the purchase of a property for East Paris Church (France)**

Hallelujah! Greetings in the name of our Lord Jesus Christ!

Dear Ministers, brothers and sisters in Christ,

Through God's guidance East Paris Church has found a premise which meets our needs in various aspects and is suitable as a church. Our purchase will be dependent on the written approval of the Council authority to use as a chapel and on the amount of funds collected.

### **Short information about the project**

**Location:** in Châtenay-Malabry, a town 11km (6,8 miles) south of Paris

**Size:** A total of 400 m<sup>2</sup> (4305 ft<sup>2</sup>) on two floors divided as: 1 main hall (chapel), 1 dining hall and kitchen, 4 rooms (2 religious education classrooms, 1 office, 1 bedroom), 2 showers and 4 toilets.

Estimated costs are:

- 909 500 € for the purchase, including solicitor's fee (7% of the building's price).
- Our financial situation is as follows:  
359 000€ in the church building fund and  
148 000 € pledge  
which results in a total amount of **507 000 €**.
- Therefore, we still need around  
**402 500 €** to cover the estimated expenses.

**Donations** may be sent to the following **account** through bank transfer:

<b>Beneficiary name:</b>	<b>ASSO TRUE JESUS CHURCH</b>
<b>Beneficiary account number:</b>	<b>IBAN FR76 1020 7000 2522 2124 1703 286</b>
<b>BIC:</b>	<b>CCBPFRRPMTG</b>
<b>Bank address:</b>	<b>Banque Populaire Rives de Paris 172 avenue Jean Jaurès 92140 CLAMART FRANCE</b>

Donation receipts will be issued upon request and subject to the receipt of your name and address. We are registered as a religious association therefore donations might be liable to tax deductions abroad, if applicable in your country's jurisdiction.

We would be grateful if brothers and sisters worldwide could support us with their donation so that we can purchase this building and continue the Holy work in a proper place of worship. We thank the Lord and gratefully thank all the members for your love and continual intercession in this matter.

May God remember your love and kindness and bless you abundantly.  
Please email us at [france@tjc.org](mailto:france@tjc.org) should you have any further questions.

Yours in Christ,

**Dn Micah Ly**  
Religious Affairs Officer  
East Paris Church



---

## More detailed information

### OUR HISTORY

- April 2012: Regular Sabbath worship in a member's house in East of Paris.
- Sept 2012: Moved to a member's flat in East of Paris.
- May 2015: Officially recognised and registered with the authorities as a religious association.
- June 2016: Moved to a friend's restaurant in central Paris.
- Sept 2016: Moved to a member's house in West of Paris.
- Sept 2017: Moved to a rented hall in East of Paris.
- Members: There are currently 42 registered members.

### HISTORY OF THE PROJECT

In April 2012, with the aim to preserve ourselves in the truth, few members gathered together temporarily for Sabbath in a member's house. This is due to Paris TJC's decision to employ YM Yang as resident preacher despite his termination by IA as preacher, and later on, his excommunication.

In September 2012, a brother offered the usage of his flat while he was working abroad. Sabbath services were held weekly with 2 RE classes and Youth Fellowship. The flat gradually became too small as the membership increased and we moved out in June 2016, when the flat was put on sale.

From June to mid-September 2016, a member's friend offered his restaurant (about 50m<sup>2</sup> (538 ft<sup>2</sup>)) to use for Sabbath services until it was time for his restaurant to open at 5pm. There was only the dining room, so RE classes could not be held.

In mid-September 2016, another opportunity was provided by God and we moved to a sister's house as she had moved to a retirement home. RE classes resumed along with various activities and fellowship. Unfortunately, we had to move out in September 2017 when the house was sold.

In September 2017, after many attempts, an Evangelical church finally accepted to let us rent a part of their premise which is a warehouse in an industrial estate. However, it is unavailable on Sundays for Convocations and we have encountered electrical shortages, no heating and water leakages.

Under God's providential care and guidance, East Paris Church was recognised and officially registered in May 2015. From then, we felt it was the right time to purchase a place to uphold the name of Jesus and further develop the divine work in France. We found a premise in 2017 but lacked the necessary funds. We continued searching and have recently found this suitable property.

### THE PROJECT

**Location:** The property is located in Châtenay-Malabry (a town 11km (6.8 miles) south of Paris). From Paris there is a fast-suburban line (RER), followed by a 13 mins bus ride or tram (expected in 2023) which stops about 3 mins walk from the property, with supermarkets at walking distance. There is parking space on the road.

It is a two-storey building and was once the town's community hall. The ceiling is 4 meters high and has double glazing throughout the building. The ground floor is covered in tiles and the first floor has wood parquet flooring.

**Size:** The main hall for the chapel is approx. 140 m<sup>2</sup> (1507 ft<sup>2</sup>). The dining hall is currently 100 m<sup>2</sup> (1076 ft<sup>2</sup>) with an open kitchen. The present owner still lives in the house and it is in a good condition.

**Attachment:** Dimension details, pictures and building plans of the property

**YouTube link:** <https://youtu.be/IXF2QrqRyjY>

**EAST PARIS CHURCH**

Phone: +33 6 73 66 75 66 / +33 6 18 22 01 14

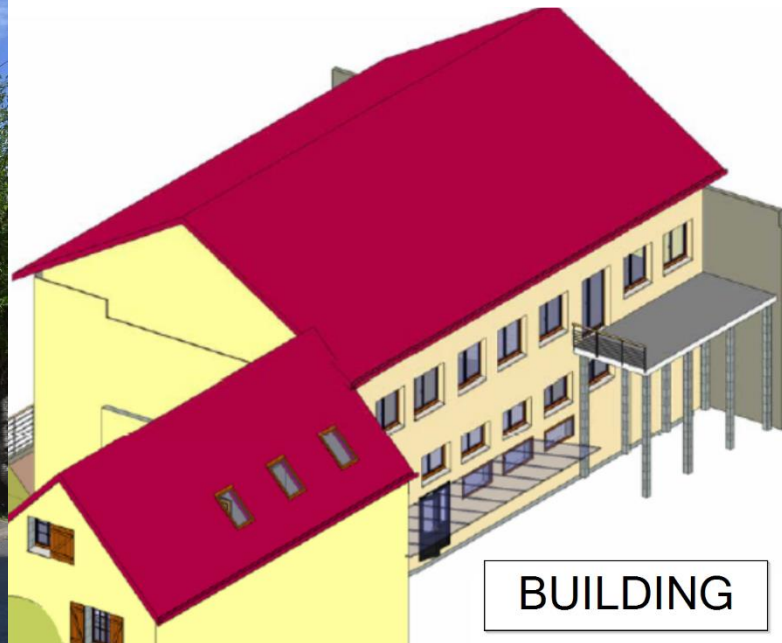
Email: [france@tjc.org](mailto:france@tjc.org)Website: [www.tjc.org](http://www.tjc.org)

First floor	Size in m <sup>2</sup>	Size in ft <sup>2</sup>
Cellar	7.10 m <sup>2</sup>	76.42 ft <sup>2</sup>
Boiler room	7.00 m <sup>2</sup>	75.34 ft <sup>2</sup>
Corridor boiler room	5.52 m <sup>2</sup>	59.41 ft <sup>2</sup>
Entrance room	9.03 m <sup>2</sup>	97.19 ft <sup>2</sup>
Chapel	138.91 m <sup>2</sup>	1,495.21 ft <sup>2</sup>
WC	9.50 m <sup>2</sup>	102.25 ft <sup>2</sup>
<b>Total</b>	<b>177.05 m<sup>2</sup></b>	<b>1,905.75 ft<sup>2</sup></b>
Second floor	Size in m <sup>2</sup>	Size in ft <sup>2</sup>
Entrance first floor	16.48 m <sup>2</sup>	177.38 ft <sup>2</sup>
Mezzanine	7.60 m <sup>2</sup>	81.80 ft <sup>2</sup>
Dining room	100.00 m <sup>2</sup>	1,076.39 ft <sup>2</sup>
Room 1	16.03 m <sup>2</sup>	172.54 ft <sup>2</sup>
Room 2	14.41 m <sup>2</sup>	155.10 ft <sup>2</sup>
Room 3	15.81 m <sup>2</sup>	170.17 ft <sup>2</sup>
Room 4	15.95 m <sup>2</sup>	171.68 ft <sup>2</sup>
Corridor	10.41 m <sup>2</sup>	112.05 ft <sup>2</sup>
Dressing	10.58 m <sup>2</sup>	113.88 ft <sup>2</sup>
Bathroom 1	9.20 m <sup>2</sup>	99.02 ft <sup>2</sup>
Bathroom 2	2.42 m <sup>2</sup>	26.04 ft <sup>2</sup>
WC 1	1.95 m <sup>2</sup>	20.98 ft <sup>2</sup>
WC 2	1.93 m <sup>2</sup>	20.77 ft <sup>2</sup>
<b>Total</b>	<b>222.84 m<sup>2</sup></b>	<b>2,398.62 ft<sup>2</sup></b>
Other	Size in m <sup>2</sup>	Size in ft <sup>2</sup>
Terrace	20.02 m <sup>2</sup>	215.49 ft <sup>2</sup>
Workshop	25.65 m <sup>2</sup>	276.09 ft <sup>2</sup>



## EAST PARIS CHURCH

Phone: +33 6 73 66 75 66 / +33 6 18 22 01 14

Email: [france@tjc.org](mailto:france@tjc.org)

Website: [www.tjc.org](http://www.tjc.org)



### 1<sup>ST</sup> FLOOR

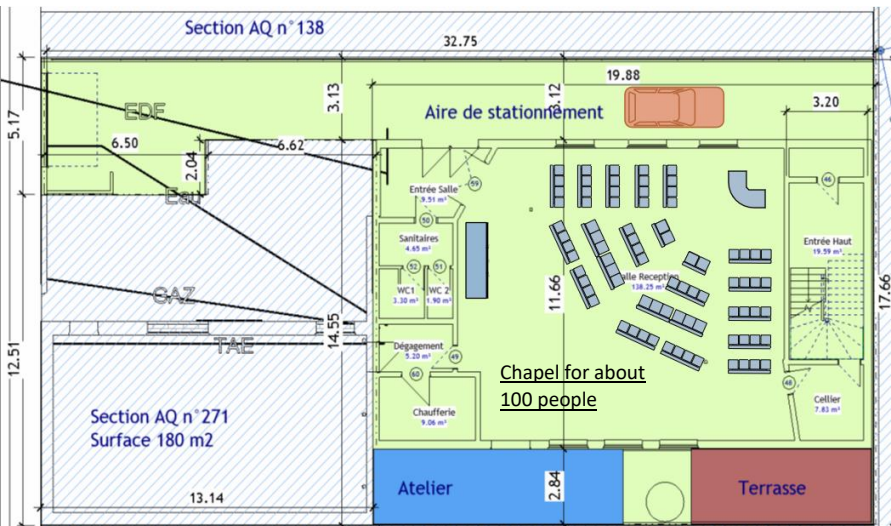

### 2<sup>ND</sup> FLOOR

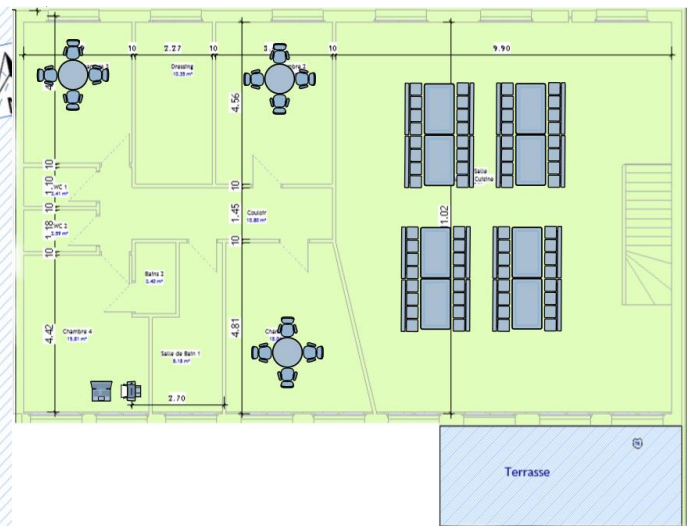

The main hall (future Chapel)



The dining hall



The bedrooms (future RE classes / Office)

